



HOME TO HOME
WOHNEN AUF ZEIT

Geschäftsführerin und Inhaberin: Eva-Jannetie Gerlach
Motzstraße 58, 10777 Berlin, Deutschland
+49 30 2191 2323, office@hometohome.de, hometohome.de
Deutsche Bank, IBAN: DE11 1007 0024 0562 0901 00, BIC: DEUTDE33HAN
USt-Id.Nr.: DE 230089808

EXCLUSIVE 2-BEDROOM APARTMENT WITH LARGE BALCONY



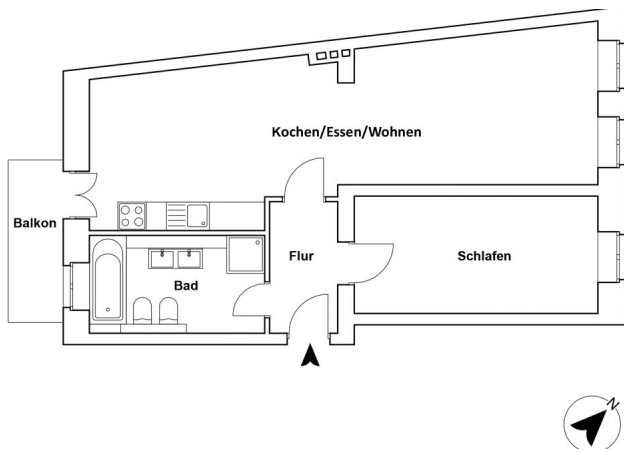

ID 5181

SIZE: ca. 75 SQM

Location: see map (approximate location)

NUMBER OF ROOMS: 2 (bedrooms: 1, living rooms: 1)

MAXIMUM BEDS: 4 (double bed, sofa bed)

BATHROOMS: 1 (1x with bathtub and shower)

PUBLIC TRANSPORT: S1, S2, S25, U8

OCCUPATION: min. 6 months

DEPOSIT: 2 monthly rents

ADDITIONAL COSTS: final cleaning

LOCATION

The apartment is located in a beautiful and central area in Berlin Mitte close to Rosenthaler Platz and Zionskirchplatz. Many cosy cafés, small shops, good restaurants and galleries in the neighbourhood. A landmark of the district is the "Ackernhalle". The "Park am Weinbergsweg" with its vast lawn invites you to relax.

DETAILS

bed linen and towels, bright, cable connection, combined washer & dryer, cosy atmosphere to live in, dishwasher, electric kettle, espresso machine, exclusive furnishing style, flagstones, flatscreen TV, generous, hi-fi system, iPad, microwave, modern-en, no pets, non-smoking, open floor plan, parquet, quality fitted kitchen, representative, sophisticated, sunny, toaster, video intercom system, well maintained, Wi-Fi

INTERIOR

central heating, energy certificate available, front building, redeveloped building

MITTE

ca. 75 SQM

2 R

Currently not available

2.200€ / M
